

B-HT submersible sewage pump for high temperature liquids

The B-HT series high-temperature submersible electric pump can handle liquids up to 80 degrees Celsius.

The insulation level, rubber material, bearings, and lubrication of the motor are upgraded on the basis of the standard type (handling liquids up to 40 degrees Celsius).

The pumps are suitable for movable soft pipe, fixed hard pipe and auto-coupling installation.

Specification

- Discharge Bore : 50-150mm
- Insulation class : H
- Protection class : IP68
- Water temperature : up to 80°C
- PH : 6 to 10
- Density of liquid : 1.05g/cm³
- Power supply :
 - three phase 380V ±10%, 50Hz
 - three phase 380V ±10%, 60Hz
- Capacity : up to 200m³/h
- Head : up to 47m
- Maximum immersion depth : 10m
- Cable length : 8m
- Cable type : Chloroprene rubber
- Mechanical seal, o-ring : FPM(FKM)
- Lubricant : Turbine oil, ISO VG46
- Bearing : Grease for high temperature use



| Model 50Hz/60Hz | Outlet | | Motor power | | Starting Method | Rated capacity | Rated head | Max capacity | Max Head | Impeller Passage | N.W |
|--------------------|--------|-----|-------------|-----|--------------------|-------------------|---------------|-------------------|-------------|---------------------|------|
| | in | mm | kW | HP | | m ³ /h | m | m ³ /h | m | mm | kg |
| 50B2.75 HT | 2 | 50 | 0.75 | 1 | D.O.L. | 10 | 10 | 26 | 12 | 25 | 22 |
| 50B21.1 HT | 2 | 50 | 1.1 | 1.5 | D.O.L. | 15 | 10 | 33 | 15 | 25 | 24 |
| 50B21.5 HT | 2 | 50 | 1.5 | 2 | D.O.L. | 15 | 15 | 37 | 20 | 20 | 40 |
| 50B22.2 HT | 2 | 50 | 2.2 | 3 | D.O.L. | 15 | 20 | 40 | 22 | 20 | 42 |
| 80B22.2 HT | 3 | 80 | 2.2 | 3 | D.O.L. | 40 | 9 | 64 | 16 | 30 | 47 |
| 50B23.0 HT | 2 | 50 | 3 | 4 | D.O.L. | 25 | 20 | 45 | 26 | 20 | 50 |
| 80B23.0 HT | 3 | 80 | 3 | 4 | D.O.L. | 40 | 13 | 75 | 20 | 30 | 55 |
| 80B24.0 HT | 3 | 80 | 4 | 5.5 | D.O.L. | 40 | 18 | 81 | 24 | 30 | 62 |
| 80B25.5 HT | 3 | 80 | 5.5 | 7.5 | D.O.L. | 45 | 20 | 88 | 28 | 35 | 77.5 |
| 100B25.5 HT | 4 | 100 | 5.5 | 7.5 | D.O.L. | 65 | 15 | 110 | 25 | 30 | 81.5 |
| 80B27.5 HT | 3 | 80 | 7.5 | 10 | D.O.L. | 40 | 30 | 80 | 40 | 30 | 94 |
| 100B27.5 HT | 4 | 100 | 7.5 | 10 | D.O.L. | 65 | 20 | 145 | 33 | 35 | 96 |
| 100B211 HT | 4 | 100 | 11 | 15 | D.O.L. | 65 | 30 | 120 | 44 | 35 | 135 |
| 150B211 HT | 6 | 150 | 11 | 15 | D.O.L. | 100 | 20/19 | 200/185 | 29/27 | 50 | 147 |
| 100B215 HT | 4 | 100 | 15 | 20 | D.O.L. | 65 | 35 | 140 | 47 | 30 | 159 |
| 150B215 HT | 6 | 150 | 15 | 20 | D.O.L. | 100 | 28 | 200 | 43 | 45 | 171 |

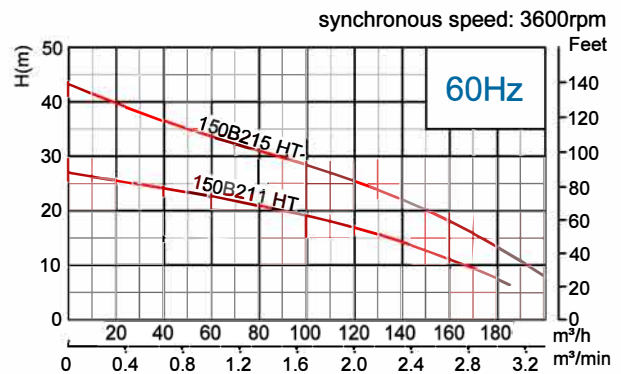
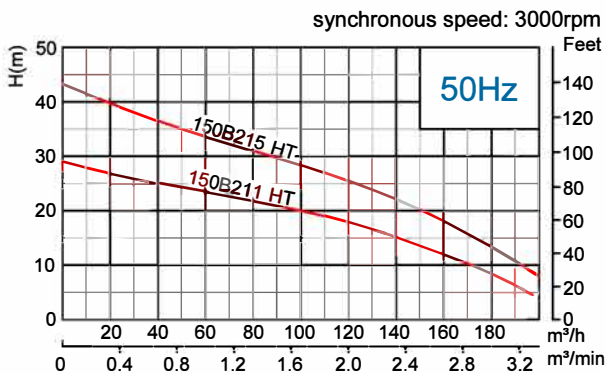
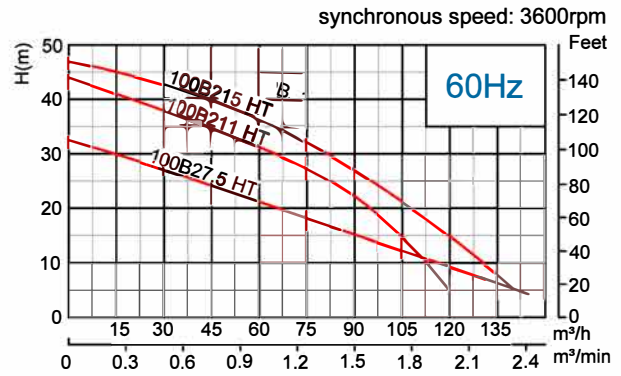
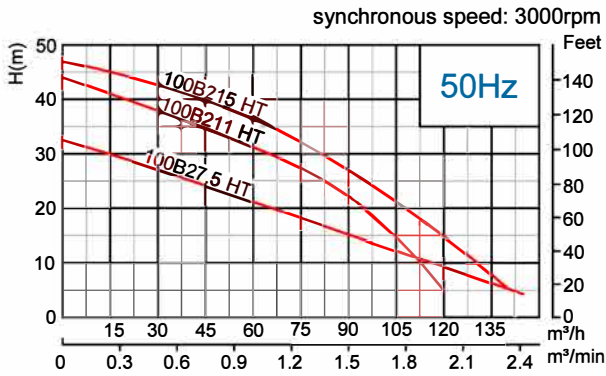
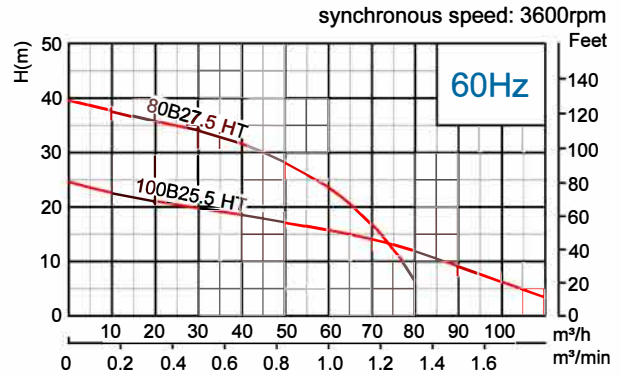
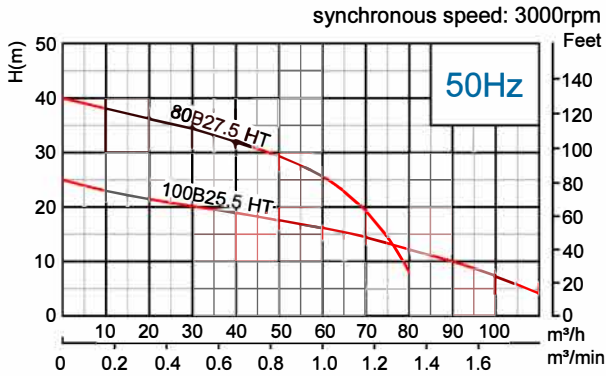
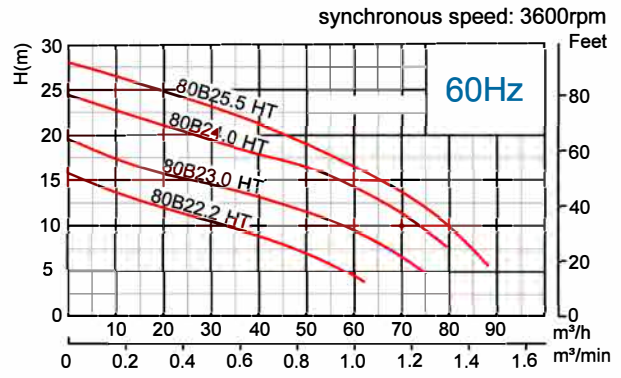
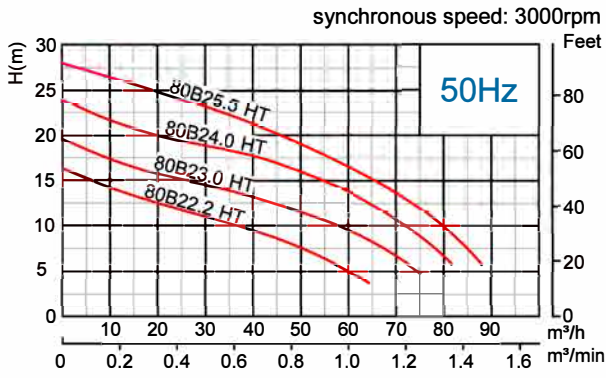
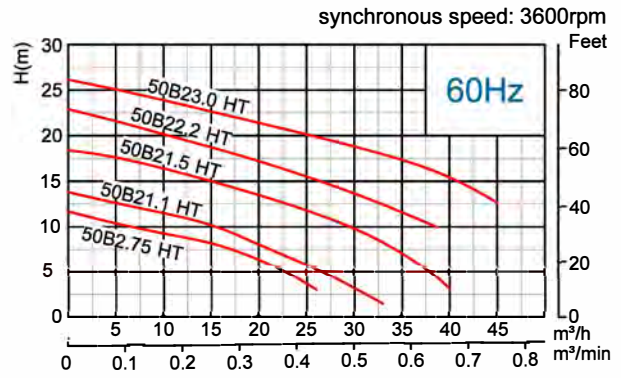
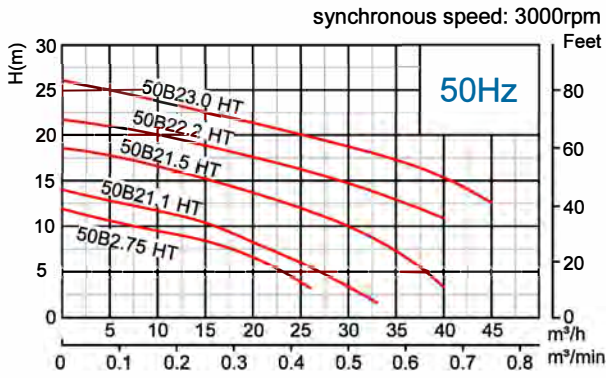

B-HT submersible sewage pump for high temperature liquids

Movable Soft Pipe Installation (R)

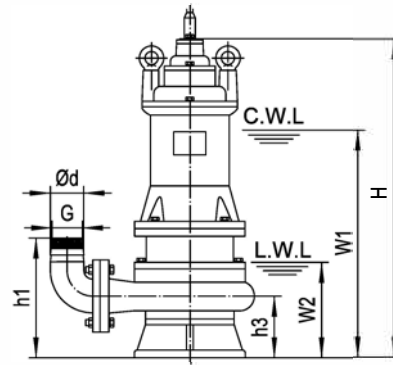
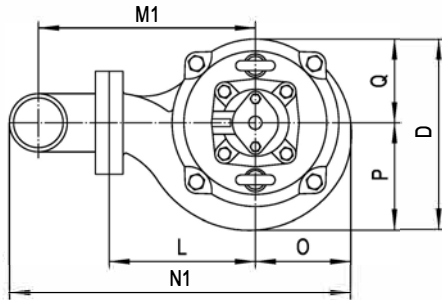

Hard Pipe Installation (Y)

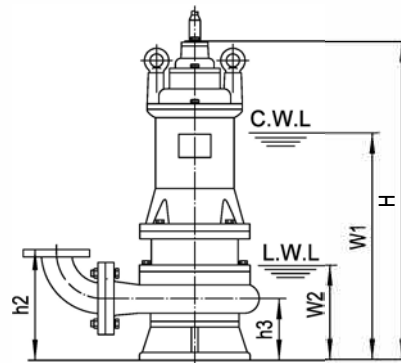
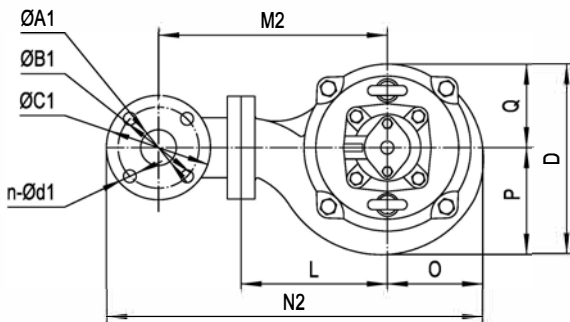

C.W.L : Continuous running water level
L.W.L : Lowest running water level

Dimensions table

| Model | Ød | G | ØA1 | ØB1 | ØC1 | n-Ød1 | h1 | h2 | h3 | W1 | W2 | H | O | P | Q | L | D | M1 | M2 | N1 | N2 |
|-------------|-----|--------------------|-----|-----|-----|-------|-----|-----|-----|-----|-----|-----|-----|-----|-----|-----|-----|-----|-----|-----|-----|
| 50B2.75 HT | 50 | G1 $\frac{1}{2}$ " | 50 | 110 | 140 | 4-Ø14 | 200 | 195 | 95 | 300 | 120 | 450 | 93 | 100 | 90 | 129 | 190 | 195 | 231 | 314 | 394 |
| 50B21.1 HT | 50 | G1 $\frac{1}{2}$ " | 50 | 110 | 140 | 4-Ø14 | 197 | 192 | 92 | 325 | 120 | 464 | 90 | 90 | 90 | 134 | 180 | 200 | 236 | 316 | 396 |
| 50B21.5 HT | 50 | G1 $\frac{1}{2}$ " | 50 | 110 | 140 | 4-Ø14 | 211 | 205 | 106 | 410 | 145 | 553 | 106 | 113 | 100 | 164 | 213 | 230 | 266 | 362 | 442 |
| 50B22.2 HT | 50 | G1 $\frac{1}{2}$ " | 50 | 110 | 140 | 4-Ø14 | 211 | 205 | 106 | 410 | 145 | 573 | 106 | 113 | 100 | 164 | 213 | 230 | 266 | 362 | 442 |
| 80B22.2 HT | 80 | G2 $\frac{1}{2}$ " | 80 | 150 | 190 | 4-Ø18 | 257 | 252 | 112 | 415 | 150 | 580 | 108 | 116 | 100 | 160 | 216 | 252 | 302 | 398 | 505 |
| 50B23.0 HT | 50 | G1 $\frac{1}{2}$ " | 50 | 110 | 140 | 4-Ø14 | 211 | 205 | 105 | 425 | 145 | 600 | 106 | 113 | 100 | 164 | 213 | 230 | 266 | 362 | 442 |
| 80B23.0 HT | 80 | G2 $\frac{1}{2}$ " | 80 | 150 | 190 | 4-Ø18 | 268 | 263 | 124 | 450 | 170 | 626 | 108 | 116 | 100 | 154 | 216 | 246 | 296 | 391 | 499 |
| 80B24.0 HT | 80 | G2 $\frac{1}{2}$ " | 80 | 150 | 190 | 4-Ø18 | 278 | 273 | 133 | 480 | 185 | 643 | 115 | 115 | 115 | 160 | 230 | 252 | 302 | 405 | 512 |
| 80B25.5 HT | 80 | G2 $\frac{1}{2}$ " | 80 | 150 | 190 | 4-Ø18 | 277 | 272 | 132 | 495 | 175 | 687 | 125 | 128 | 125 | 180 | 253 | 272 | 322 | 429 | 537 |
| 100B25.5 HT | 100 | — | 100 | 170 | 210 | 4-Ø18 | 305 | 285 | 135 | 505 | 190 | 697 | 129 | 140 | 125 | 181 | 265 | 283 | 333 | 461 | 567 |
| 80B27.5 HT | 80 | G2 $\frac{1}{2}$ " | 80 | 150 | 190 | 4-Ø18 | 291 | 286 | 146 | 520 | 190 | 684 | 150 | 150 | 150 | 200 | 300 | 292 | 342 | 480 | 587 |
| 100B27.5 HT | 100 | — | 100 | 170 | 210 | 4-Ø18 | 326 | 306 | 156 | 540 | 210 | 700 | 150 | 150 | 150 | 200 | 300 | 303 | 354 | 502 | 608 |
| 100B211 HT | 100 | — | 100 | 170 | 210 | 4-Ø18 | 344 | 324 | 174 | 600 | 230 | 829 | 162 | 162 | 162 | 202 | 324 | 304 | 354 | 516 | 621 |
| 150B211 HT | 150 | — | 150 | 225 | 280 | 8-Ø18 | 404 | 379 | 179 | 615 | 245 | 844 | 162 | 162 | 162 | 210 | 324 | 364 | 414 | 600 | 708 |
| 100B215 HT | 100 | — | 100 | 170 | 210 | 4-Ø18 | 349 | 329 | 179 | 680 | 230 | 900 | 162 | 162 | 162 | 220 | 322 | 370 | 372 | 534 | 640 |
| 150B215 HT | 150 | — | 150 | 225 | 280 | 8-Ø18 | 410 | 385 | 185 | 680 | 245 | 914 | 162 | 162 | 162 | 230 | 383 | 283 | 434 | 620 | 729 |

Weights & Packing dimensions

| Model | R | | | Y | | |
|------------|-----|------|-------------------|-----|------|-------------------|
| | N.W | G.W | Packing dimension | N.W | G.W | Packing dimension |
| | kg | kg | mm | kg | kg | mm |
| 50B2.75 HT | 22 | 23.5 | 480×255×240 | 24 | 25.5 | 480×265×310 |
| 50B21.1 HT | 24 | 25.5 | 495×255×240 | 26 | 27.5 | 495×265×310 |
| 50B21.5 HT | 40 | 46 | 670×260×315 | 42 | 48 | 670×260×315 |
| 50B22.2 HT | 42 | 48 | 690×260×315 | 44 | 50 | 690×260×315 |
| 80B22.2 HT | 47 | 52 | 710×260×315 | 51 | 56 | 710×260×325 |
| 50B23.0 HT | 50 | 55 | 710×260×315 | 52 | 57 | 710×260×315 |
| 80B23.0 HT | 55 | 60 | 750×240×325 | 59 | 64 | 750×240×335 |
| 80B24.0 HT | 62 | 68 | 765×260×325 | 66 | 72 | 800×260×335 |

| Model | R | | | Y | | |
|-------------|------|------|-------------------|------|------|-------------------|
| | N.W | G.W | Packing dimension | N.W | G.W | Packing dimension |
| | kg | kg | mm | kg | kg | mm |
| 80B25.5 HT | 77.5 | 83.5 | 800×290×335 | 81.5 | 87.5 | 800×290×365 |
| 100B25.5 HT | 81.5 | 89.5 | 810×300×375 | 87.5 | 95.5 | 810×300×405 |
| 80B27.5 HT | 94 | 102 | 815×355×445 | 123 | 135 | 815×355×465 |
| 100B27.5 HT | 96 | 104 | 815×355×445 | 129 | 141 | 815×355×475 |
| 100B211 HT | 135 | 147 | 935×365×485 | 141 | 153 | 935×365×505 |
| 150B211 HT | 147 | 159 | 955×385×535 | 155 | 167 | 955×385×545 |
| 100B215 HT | 159 | 171 | 1000×355×515 | 165 | 177 | 1015×355×535 |
| 150B215 HT | 171 | 183 | 1010×365×555 | 179 | 191 | 1025×365×565 |

Auto-Coupled Installation (Z)

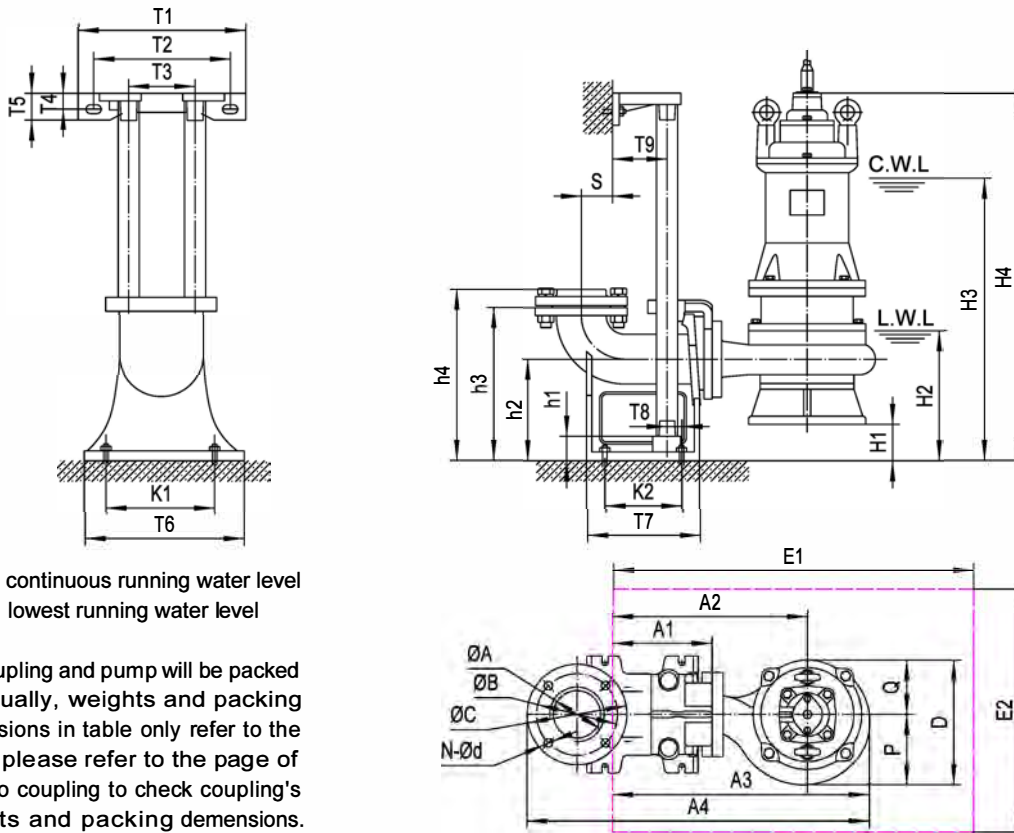

C.W.L : continuous running water level
L.W.L : lowest running water level

The coupling and pump will be packed individually, weights and packing dimensions in table only refer to the pump, please refer to the page of TO auto coupling to check coupling's weights and packing dimensions.

Dimensions table

| Auto coupling | ØA | ØB | ØC | N-Ød | T1 | T2 | T3 | T4 | T5 | T6 | T7 | T8 | T9 | K1 | K2 | S | h1 | h2 | h3 | h4 |
|-----------------|------------|-----|-----|-------|-----|-----|-----|----|----|-----|-----|----|----|-----|-----|-----|-----|-----|-----|-----|
| TO 50-50(PN6) | Ø50 / G2" | 110 | 140 | 4-Ø14 | 265 | 215 | 105 | 22 | 42 | 200 | 215 | 15 | 67 | 163 | 135 | 65 | 25 | 160 | 250 | 276 |
| TO 80-80(PN6) | Ø80 / G3" | 150 | 190 | 4-Ø18 | 315 | 265 | 145 | 27 | 50 | 255 | 230 | 35 | 78 | 215 | 155 | 79 | 25 | 185 | 305 | 335 |
| TO 100-100(PN6) | Ø100 / G4" | 170 | 210 | 4-Ø18 | 365 | 305 | 170 | 30 | 55 | 293 | 262 | 34 | 95 | 265 | 176 | 97 | 23 | 225 | 350 | 381 |
| TO 150-150(PN6) | Ø150 / G6" | 225 | 285 | 8-Ø18 | 400 | 260 | 280 | 24 | 48 | 360 | 410 | 90 | 95 | 285 | 300 | 195 | 390 | 300 | 480 | — |

Dimensions table

| Model | Auto coupling | H1 | H2 | H3 | H4 | A1 | A2 | A3 | A4 | P | Q | D | E1×E2 | Pump weight & packing dimension | | |
|-------------|---------------|-----|-----|-----|------|-----|-----|-----|------|-----|-----|-----|---------|---------------------------------|------|-------------------|
| | | | | | | | | | | | | | | N.W | G.W | Packing dimension |
| 50B2.75 HT | 50-50(PN6) | 65 | 185 | 365 | 515 | 157 | 286 | 379 | 514 | 100 | 90 | 190 | 650×550 | 20 | 21.5 | 480×255×240 |
| 50B21.1 HT | 50-50(PN6) | 68 | 188 | 393 | 532 | 157 | 291 | 381 | 516 | 90 | 90 | 180 | 650×550 | 22 | 23.5 | 495×255×240 |
| 50B21.5 HT | 50-50(PN6) | 54 | 199 | 464 | 607 | 157 | 321 | 427 | 562 | 113 | 100 | 213 | 650×550 | 38 | 44 | 670×260×315 |
| 50B22.2 HT | 50-50(PN6) | 54 | 199 | 464 | 627 | 157 | 321 | 427 | 562 | 113 | 100 | 213 | 650×550 | 40 | 46 | 690×260×315 |
| 80B22.2 HT | 80-80(PN6) | 73 | 223 | 488 | 653 | 183 | 343 | 451 | 625 | 116 | 100 | 216 | 650×550 | 42 | 47 | 710×260×315 |
| 50B23.0 HT | 50-50(PN6) | 55 | 200 | 480 | 654 | 157 | 321 | 427 | 562 | 113 | 100 | 213 | 650×550 | 48 | 53 | 710×260×315 |
| 80B23.0 HT | 80-80(PN6) | 61 | 231 | 511 | 688 | 183 | 337 | 445 | 619 | 116 | 100 | 216 | 650×550 | 50 | 55 | 750×240×325 |
| 80B24.0 HT | 80-80(PN6) | 52 | 237 | 532 | 695 | 183 | 343 | 458 | 632 | 115 | 115 | 230 | 650×550 | 57 | 63 | 765×260×325 |
| 80B25.5 HT | 80-80(PN6) | 53 | 230 | 550 | 740 | 183 | 363 | 488 | 662 | 128 | 125 | 253 | 700×550 | 72.5 | 78.5 | 800×290×335 |
| 100B25.5 HT | 100-100(PN6) | 90 | 280 | 595 | 788 | 203 | 384 | 513 | 715 | 140 | 125 | 265 | 700×550 | 75.5 | 83.5 | 810×300×375 |
| 80B27.5 HT | 80-80(PN6) | 27 | 237 | 567 | 789 | 183 | 383 | 546 | 720 | 162 | 162 | 324 | 750×550 | 89 | 97 | 815×355×445 |
| 100B27.5 HT | 100-100(PN6) | 51 | 281 | 611 | 835 | 203 | 405 | 568 | 770 | 162 | 162 | 324 | 750×550 | 90 | 98 | 815×355×445 |
| 100B211 HT | 100-100(PN6) | 51 | 281 | 651 | 880 | 203 | 405 | 568 | 770 | 162 | 162 | 324 | 750×550 | 129 | 141 | 935×365×485 |
| 150B211 HT | 150-150(PN6) | 121 | 366 | 736 | 965 | 288 | 498 | 660 | 998 | 162 | 162 | 324 | 750×550 | 135 | 147 | 955×385×535 |
| 100B215 HT | 100-100(PN6) | 46 | 276 | 726 | 946 | 203 | 423 | 585 | 787 | 162 | 162 | 324 | 750×550 | 154 | 166 | 1000×355×515 |
| 150B215 HT | 150-150(PN6) | 115 | 360 | 795 | 1029 | 288 | 518 | 680 | 1018 | 162 | 162 | 324 | 850×550 | 161 | 173 | 1010×365×555 |