

Formidra

La douche à vivre !

Douche solaire

GUIDE D'INSTALLATION & D'UTILISATION



Solar shower

INSTALLATION GUIDE AND USER'S MANUAL



Ducha solar

GUÍA DE INSTALACIÓN Y USO



Doccia solare

MANUALE D'INSTALLAZIONE E DI UTILIZZO



Solardusche

INSTALLATIONS UND BEDIENUNGSANLEITUNG



Made in  **Poolstar**

INSTALLATION GUIDE AND USER'S MANUAL

This solar shower is intended for external use, near a swimming pool, on a beach or in a garden. Before using your new solar shower, please read the recommendations and the user's manual.

CAUTION

During the hottest days of summer, it is possible that the temperature of the water contained in the tank exceeds 60°C. Before taking a shower, mix the water, put the mixer on «cold water» and then adjust the temperature progressively until obtaining a pleasant temperature.

Do not touch the surface of the shower in order to avoid any risk of superficial burns.

It is possible that water continues to run after turning off the shower. This is normal and it stops within the following 10 – 15 seconds.

Do not use the shower in case of storms, in order to avoid any risks of lightning.

The solar shower is designed to be used under “normal” water supply conditions, with a pressure lower than 3 bars (3 kg).

INSTALLATION

1. Choose a location well exposed to direct sunlight (ideally to 360°) near a water supply and drainage. The support must be solid (concrete floor, slab, tiled floor, wooden deck, heavy wooden grating, anti moisture treated.)
2. Drill the bracket in front of the shower attachment holes. 4 holes approximately of 12mm of diameter and of 70 mm of depth, using the base of the shower as a reference. The drilling templates are available on www.formidra.fr
3. Insert the dowels and fix the solar shower vertically using a spirit level, correct the verticality with washers if necessary.
4. Assemble the showerhead with the joints provided, Install the shower head fastening it on the shower body.
5. **Jolly Go model only:** assemble the foot rinse and the shower holder by screwing it onto the body of the shower. Make sure to put the seal between the 2 parts.

(If the seal is not sufficient, add a strip of Teflon around the male thread)



PRESSURE REDUCER

Assemble the pressure reducer and the threaded tap connector then fastened it on water inlet. Connect to the water supply with the adapter included.

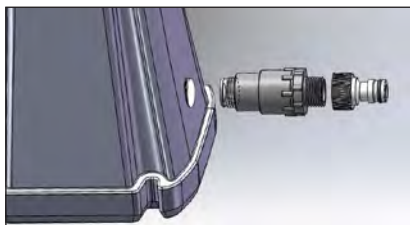

1ST USE

Once the shower is connected to water, Open the tap (hot water) in order to release the air contained in the shower and to allow the tank of the shower to fill completely.

When the water starts to drop from the head of the shower, this means that the tank of the solar shower is full. At that point you can turn off the shower tap and wait for the water inside the tank to be heated. Cold water is immediately available.

USE

When the water is heated by the sun in summer, a little quantity of water may drop from the head of the shower. This is normal, because the volume of the water inside the shower increases due to the heat.

The shower and the foot washer can be used separately or simultaneously. Only the shower can provide a mix of hot and cold water. The other elements provide only cold water.

In case of continuous use, you will see a drop in the temperature of water, being the duration of the sunlight insufficient.

MAINTENANCE AND WINTER

After a prolonged use, it is possible that limestone and other deposits form on the head of the shower. Turn off the water supply in order to remove the shower head to clean it.

The solar shower is designed to be used under conditions of an external temperature above 15°C.

At the end of the season of use, close the water supply. In the areas where the external temperature drops below 3°C, make sure to drain the tank, in order to avoid damages caused by frost.

It is advisable to put your shower in the shelter or to protect it with a protective cover available as an option, outside periods of use.

WARRANTY

POOLSTAR warrants to the original end user customer or purchaser that the product is free from defects in material and workmanship for a period of two (2) years. This warranty does not cover damages caused by frost.

The warranty can not be applied if the supplied pressure reducer is not installed when it is first used.

For further information, please visit our website at <http://support.poolstar.fr>

'formidra

La douche à vivre !

Ed. 09/2019

Made in  Poolstar