

Please read all instructions  
before using this product.  
Please keep this manual for  
future reference.

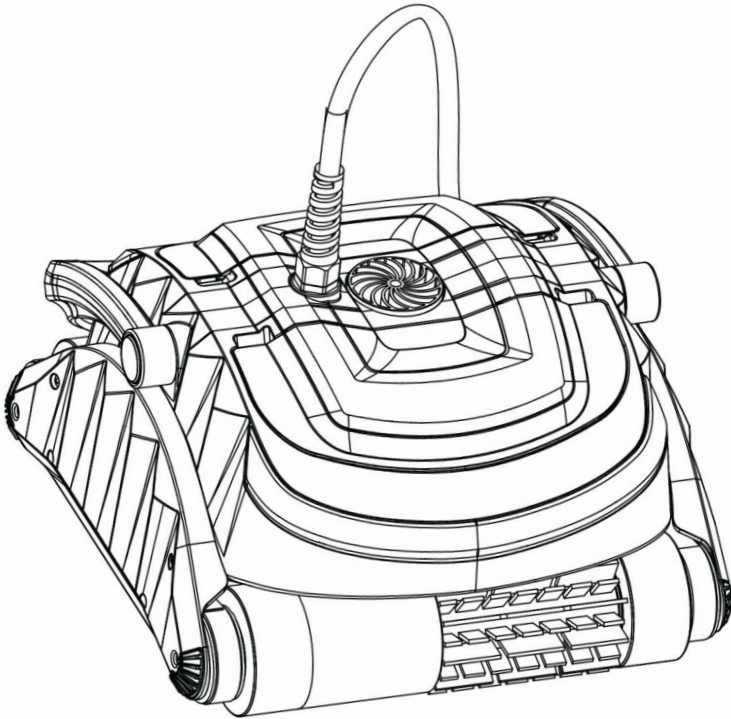

# Instructions for Use

## Pool Cleaning Robot

# XT0010

## Index

1. Product Introduction
2. Function and Operation Instructions
3. Routine Maintenance
4. Specifications
5. Troubleshooting
6. Parts Breakdown and Replaceable Parts List
7. Warranty and After-sales Information
8. Important Safety Notes

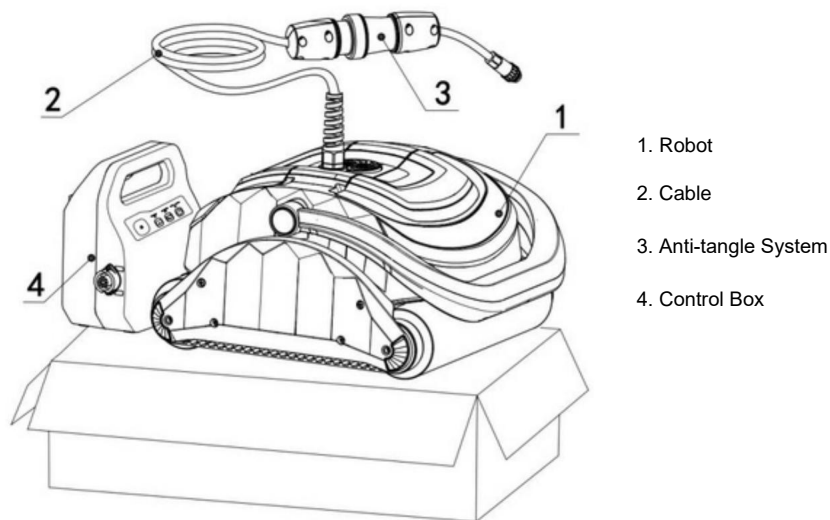

# General information

Dear Customer: Congratulations! You have purchased a highly advanced robotic pool cleaner. The robot is easy to use and will help you clean your pool. Please follow this manual to operate the robot; your robot will follow your settings to clean your pool quickly and efficiently.

**PLEASE READ AND FOLLOW THE INSTRUCTIONS CAREFULLY BEFORE PUTTING YOUR ROBOT INTO SERVICE BEFORE USING IT.**

Deterioration, discoloration, or brittleness of any pool surface finish may occur over time, separately or in combination with age, incorrect pool water chemistry, improper installation, and other factors. The customer hereby disclaims any and all claims and releases the manufacturer from any and all claims for damage to any plaster or vinyl liner in the customer's pool caused by the use and/or operation of the cleaner. Under no circumstances shall the manufacturer be liable for any loss or damage, whether direct, indirect, consequential, or incidental, resulting from the use of or inability to use the cleaner in the customer's pool.

## Features

- The pool cleaner independently scrubs, vacuums and filters your pool.
- No installation, no attachments required. Simply drop in and turn on. It is completely automatic.
- Filter cleaning is much easier with top-loading filter cartridges.
- Electronic self-diagnosis and overload protection.
- Cross obstacle crossing function prevents the robot from bumping the obstacle.
- Enhanced motor prevents the robot from being sucked into an American-style floor drain.
- The modular design makes removing or replacing the wheel brush as easy as possible.
- The unique design allows the robot to climb the pool steps correctly.
- The robot operates normally when the water level reaches 35cm.
- It works in all shapes of pools.

## Operating Instructions

### Opening the packaging

Remove the CLEANER by placing the cardboard down and pulling it out as shown.

The control box and the introductory manual are also included in the box.

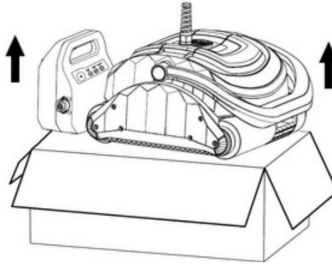

### Brief Introduction:

#### 1. Switch (on/off)

Robot operation switch.

#### 2. Bottom cleaning mode only (blue light on).

The robot only cleans the pool floor, which improves significantly increase efficiency.

#### 3. Universal cleaning mode (blue light on).

The robot cleans the pool in all areas, including the floor, walls and waterline.

#### 4. Operating time

Selecting the operating time of the robot (green light indicates 5 hours of operation, blue light indicates 2 hours of operation).

Instructions for use 1. Connect the floating power cable as shown in the figure below.

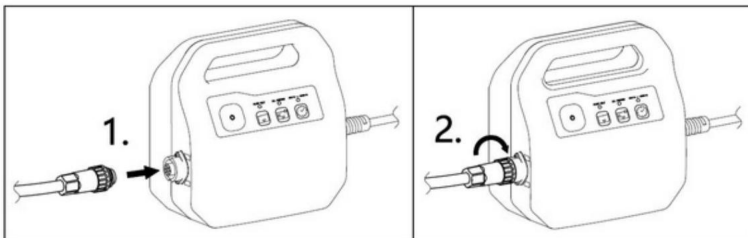

2. Place the control box 3.5 meters away from the pool (you can fix it with a hook or magic tape) to prevent the robot from pulling the control box into the water.



3. Place the pool cleaner in the pool. Release the pool cleaner and let it fall to the bottom of the pool. Make sure the floating cable is free of any obstructions.

4. When the control box is powered by electricity (230V AC 50HZ or 110V AC 60HZ, depending on the local voltage), one of the three modes will light up. Press the desired mode button, then press the start/stop button, the robot starts working.

5. Mode change: When the robot is working, first press the start/stop button to stop the robot, then choose the new mode and press the start/stop button again to start the robot. As shown in the figure below.

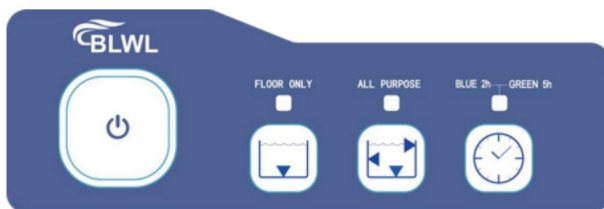

On / OFF

#### LED light indicator

Button	Light	Status	Indication
On / Off	Blue	Always ON	Functioning normal
Floor cleaning only	Blue	Always ON	Functioning normal
Multi-purpose cleaning	Blue	Always ON	Normal operation
Duration functioning	Blue/ Green	Always ON	Blue light: Work 2 hours Green light: Work 5 hours
All lights	Rouge	Always ON	No-charge protection: The robot stops automatically. The "Floor Only" mode indicator light turns red, the other indicators turn off. Overload protection: The robot stops automatically. The "Floor Only" and "Versatile" mode indicators turn red, the other indicators turn off. No-signal protection: The robot stops automatically. The indicators of all 3 modes turn red.

## Regular maintenance

### 1. Cleaning the filter basket

Turn off the robot, disconnect the power from the control box, open the top cover of the robot to remove the filter basket, clean the filter basket with a garden hose, and then put it back in the robot when finished.

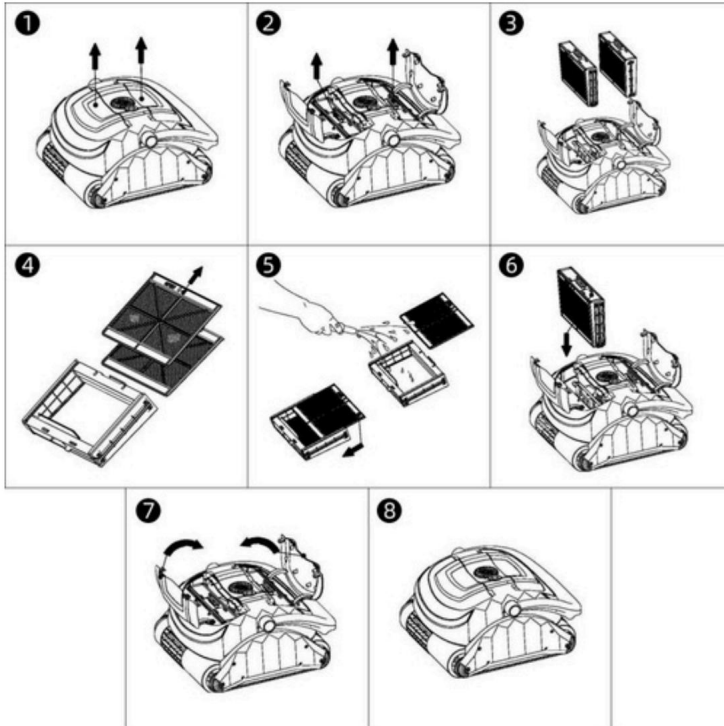

**\*Note:** Ensure the power is turned off and unplugged after use. For best cleaning results, it is strongly recommended to thoroughly clean the filter basket after each use.

Please place the pool vacuum in a clean and dry place.

### 2. Regular maintenance of the floating power cord

After a few hours of use, the power cords may become tangled, even though the appliance is equipped with a swivel cord. If this happens, untangle it manually before turning it back on. Once you're done cleaning, put away the floating blue power cord and secure it with magic tape.

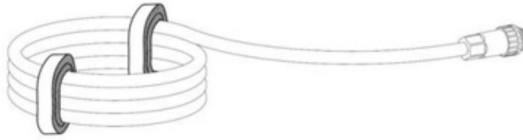

**3. How to remove the wheel brush** Step 1: Use a small screwdriver to unscrew as shown below.

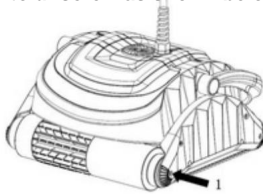

**Step 2:** Remove the wheel brush as shown in the picture below.

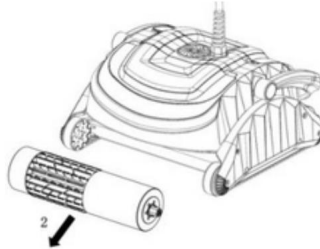



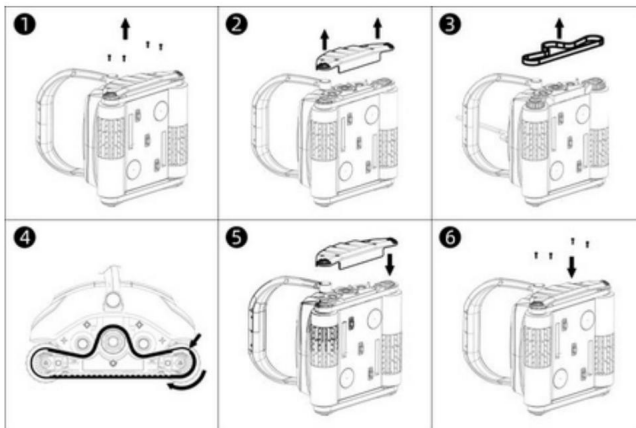





**4. How to change the drive belt** Turn off the robot, unplug the power cord. Place the robot on its side. Remove the 4 bolts on the plastic side cover to remove the cover, then replace it with a new one as shown in the picture below. After replacement, screw the side cover back on.



## Specifications

Dimension du produit	450 X 405x 236 mm	Tension de sortie	24V DC
Dimension de l'emballage	490 X 470x 410 mm	Courant de sortie	4.5A
Poids du produit	Environ 9.5 KG	Tension d'entrée	230V or 110V (Dépend de tension locale)
Poids brut	Environ 17 KG	Fréquence	50Hz
Zone du nettoyage	Sol, mur et ligne d'eau	Puissance	130W
Précision de filtration	5um	Classe IP pour le boîtier du contrôleur	IP65
Longueur du câble d'alimentation flottant	17m	Classe IP pour le moteur	IP68
Vitesse de filtrage	14-18 m³/h	Garantie	2 ans

## Warning and precautions

Warning	
	It is forbidden to swim in the pool while the robot is working. Please remove the robot from the water before entering the pool.
	DO NOT allow children to use this product unless under close parental supervision.
	DO NOT turn on the pool robot before it is submerged in water, as this may damage the motor seal and invalidate the warranty.
	Turn off the power and unplug it from the electrical outlet before removing the cleaner from the pool.
	DO NOT pull the cable to remove the robot from the water, you must hold the handle to remove it.
	The robot's working water temperature is 5-35°C, the working water depth is 0.5M-3M, and the maximum cleaning area is 100M².
	The box (or control box) must be placed in a dry place and kept at least 3.5 m from the pool.
	Make sure the power supply is turned off and unplugged after use, and place the pool cleaner in a clean, dry place.



## Troubleshooting

Observation	Possible reason	Solutions
The vacuum cleaner moves but does not clean the pool	The filter basket is clogged	Cleaning the filter basket
The pool cleaner cannot go down to the bottom	The filter basket net is clogged	Cleaning the filter basket
The pool cleaner suddenly stops	The propeller may be blocked or obstructed by debris	Unplug the power supply electric. Open the turbine cover and make sure nothing is stuck in the turbine.
	The belt drive may be blocked by debris	Check that nothing is blocking the tracks or wheels.
Debris comes out of the exit	The filter basket is broken	Replace the filter basket if it is damaged.
	The filter basket is full	Clean the filter basket
The floating cable gets twisted	Too long operation	Untwist the floating cable before restarting.
Stop operation (LED red)	Overload protection when no load is present or of	<p>1. Overload Protection: The robot will automatically shut down. You need to press and hold the On/Off button to reset the pool robot until the blue light comes back, then you can put it into the pool and turn it on again.</p> <p>2. No-charge protection: If you turn on the robot before putting it in water, it will trigger no-charge protection.</p> <p>You need to press and hold the ON/OFF button to reset the robot until the blue light returns, then put it in the pool and turn it on again. If the water depth is less than 30 cm, the device triggers the no-charge protection. The minimum water level is 35 cm.</p> <p>3. No Signal Protection: If this happens, it means the control box is not properly connected to the robot.</p> <p>Please check that the cable between the control box and the robot is properly connected. If the light is still on, unplug the cable and plug it back in. If the cable is properly connected, the light will automatically turn on again.</p> <p>the</p>

## Product overview and interchangeable parts

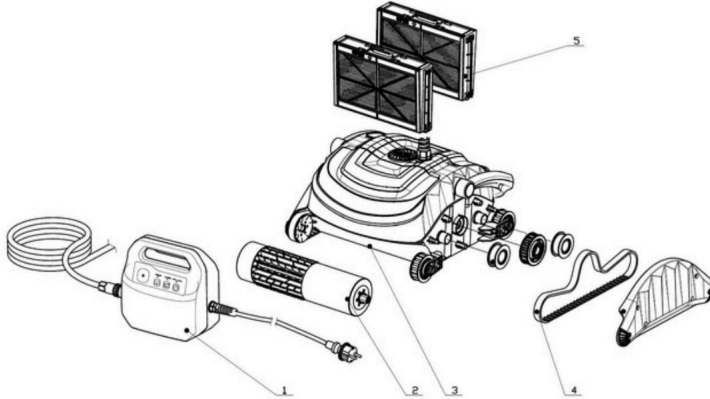

1. Control box 2. Wheel brush 3. Main body 4. Drive belt 5. Filter box

### Warranty and After-Sales Information

All our products are covered by a 2-year warranty against manufacturing or material defects from the date of purchase. Any warranty claim must be accompanied by a receipt or invoice showing the date of purchase. Therefore, we recommend that you keep your receipt.

Limited repairs or replacements will be provided during the warranty period, and the warranty does not cover damage caused by freezing and chemicals. All other costs (transportation, labor, etc.) are excluded from the warranty period. We are not responsible for any direct or indirect losses due to improper installation, connection, and incorrect operation.

These wear parts are not covered by the warranty.

Wear parts are as follows:

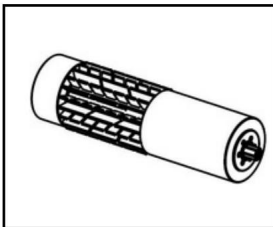

**Wheel Brush**

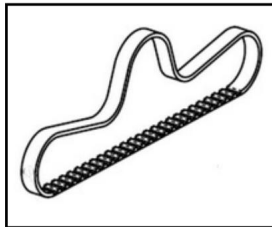

**Drive Belt**

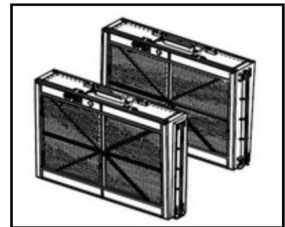

**2 Filter Boxes**

### IMPORTANT SAFETY INSTRUCTIONS

The robot cleaner has been manufactured with the utmost care and safety in mind.  
We suggest the following precautions as part of your pool safety:

#### SAVE THESE INSTRUCTIONS

1. ALWAYS PUT THE MACHINE IN WATER BEFORE PLUGGING IT INTO THE ELECTRICAL SOCKET.
2. IT IS IMPORTANT TO REMOVE THE DEVICE FROM THE WATER IMMEDIATELY AFTER USE. THIS CAN IMPROVE THE LIFESPAN OF THE DEVICE.
3. ENSURE THAT THE APPLIANCE IS PLUGGED ONLY INTO A GROUNDED OUTLET EQUIPPED WITH AN APPROVED AND PROPERLY OPERATING GROUND FAILURE CIRCUIT INTERRUPTER (GFCI).
4. DO NOT HANDLE THE APPLIANCE WHILE IT IS PLUGGED INTO THE OUTLET.
5. DO NOT USE AN EXTENSION CORD UNLESS THE CONNECTION IS SECURE AND THE USE OF THE EXTENSION CORD DOES NOT POSE A SAFETY ISSUE
6. ALWAYS STAY IN THE POOL WHEN THE DEVICE IS OPERATING.
7. NEVER LET THE PLUG ENTER THE POOL.
8. DO NOT OPERATE THE UNIT OUT OF WATER. THIS WILL DAMAGE THE MOTOR SEAL AND VOID THE WARRANTY.
9. DO NOT PULL THE MACHINE OUT OF THE POOL AGAINST THE SIDE WALL. THIS COULD DAMAGE THE DEVICE AND/OR THE WALL OF YOUR POOL.
10. DO NOT REPAIR THE CORD. REPLACE ANY DAMAGED CORD.
11. WARNING - DO NOT ALLOW CHILDREN TO USE THIS PRODUCT UNLESS THEY ARE CLOSELY SUPERVISED BY THEIR PARENTS AT ALL TIMES.
12. IF THE POWER CORD IS DAMAGED, IT MUST BE REPLACED BY THE MANUFACTURER'S SERVICE AGENT OR AUTHORIZED QUALIFIED PERSONNEL IN ORDER TO AVOID ANY HAZARD.

Although the CLEANER has been designed to operate as safely as possible, we suggest that you exercise reasonable care when handling the robotic machine and frequently inspect the power cord for damage, tears, and wear, as with the use of any other electrical appliance. After each use, remove the robot from the pool, rinse it with fresh water, and remove any twists in the cord.

### PREVENTIVE MAINTENANCE

To maximize efficiency and obtain long-term service from your pool cleaner, we suggest the following:

1. Rinse the entire unit thoroughly after use.
2. Clean the filter baskets thoroughly after each use. Clogged filters can significantly reduce the efficiency of the appliance.
3. Remove any twists from the cord after use. Twists should be minimal if the appliance is working properly. It is helpful to lay the cord straight in sunlight.
4. Avoid letting the appliance "cool" in water.
5. Inspect filter belts and baskets frequently. Replace them if necessary.

